



Program, Location, and Land Use Master Plan (PLLUMP)– Step 3 Facilities Master Plan

CPC Meeting: May 3, 2016





Context

- This is the next step in the development of a Facilities Master Plan for all three SBCC campuses. The initial activities in Step 3A were to assess the existing conditions of the site and its buildings and obtain feedback on zoning concepts from Core Team and Infrastructure Services Group. At the Governing Bodies Workshop on April 22nd, we gathered ideas for locating site and building programs for Main Campus. We also reviewed and gathered feedback of drafted block diagram schemes for Wake and Schott Campuses.



Purpose & Intended Results

- Review draft Block Diagram Scenarios for Main Campus
- Review draft Block Diagram Scenarios for Wake and Schott
- Review input from Governance Bodies on draft Block Diagram Scenarios of site and program adjacencies.
- Collect feedback on Program Cluster and Location Concepts



Agenda

- Process Map Review
- Governance Bodies Workshop
 - Workshop Format and Exercise
 - Key Findings
 - Main Campus
 - Wake Campus
 - Schott Campus
- Review CLL Feedback
- Conclusion
- Next Steps



Step 3: Process Map

Step 3: Process Map

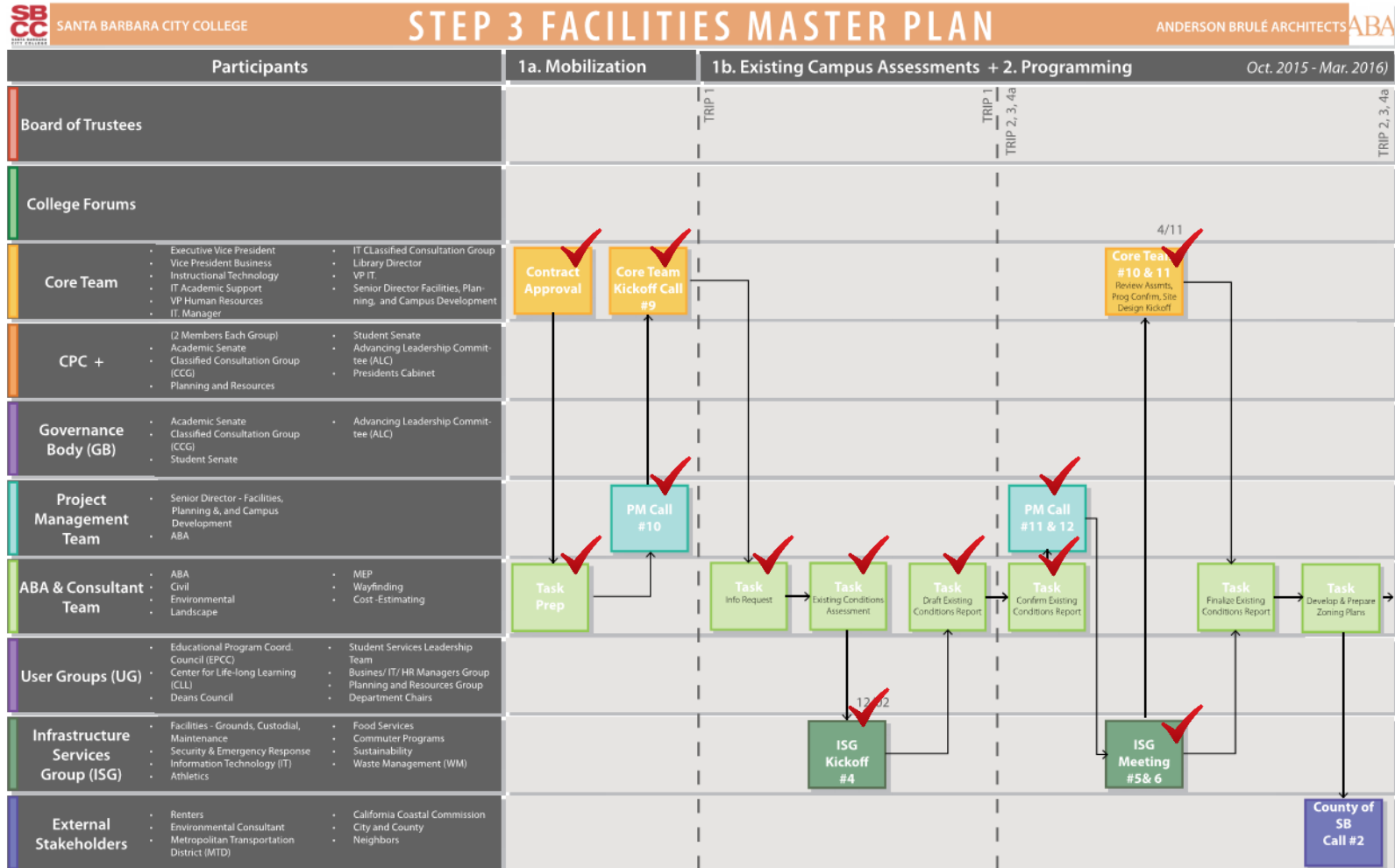

Step 3: Process Map

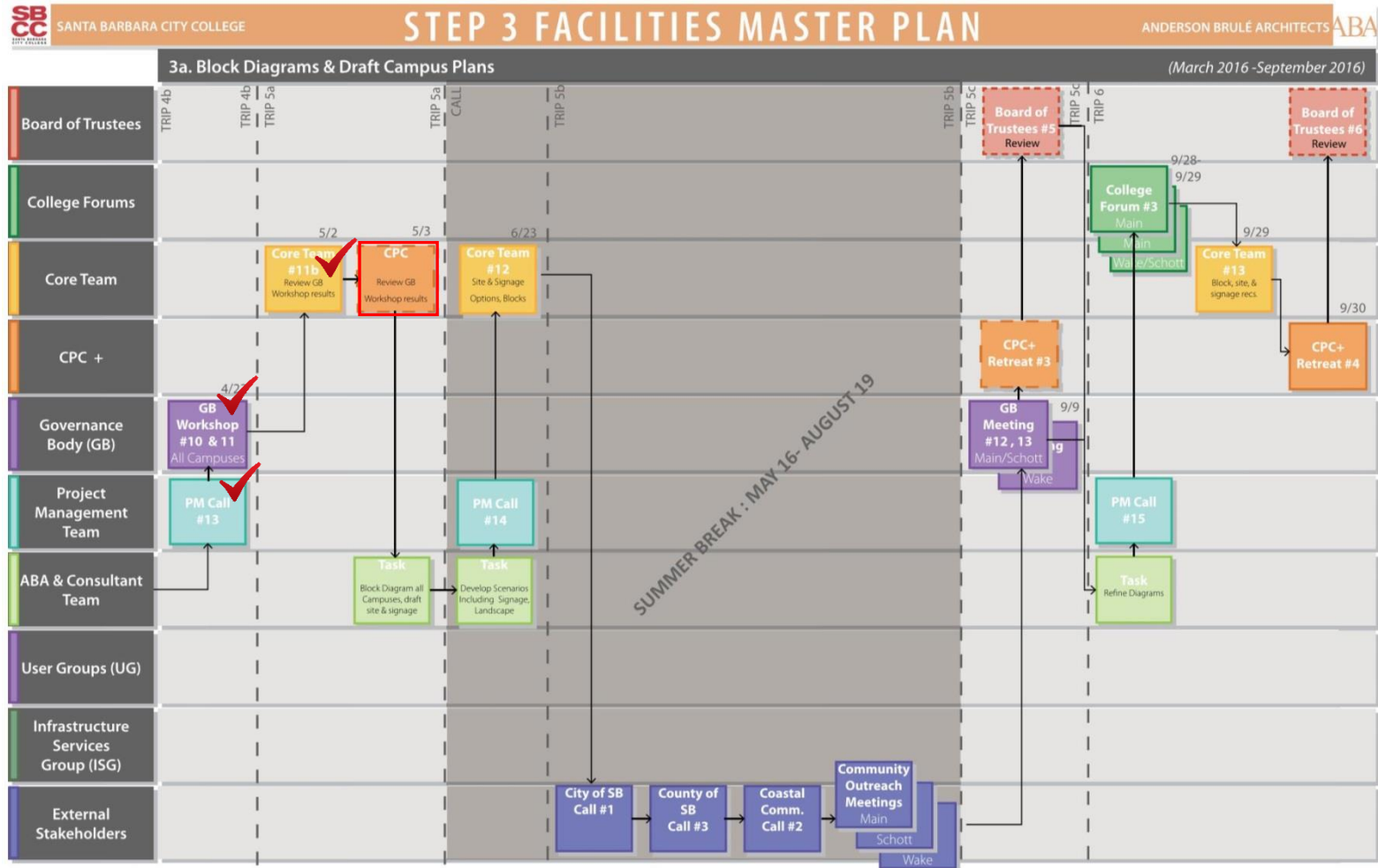

Step 3: Process Map (Step 3B : 9/2016-2/2017)

3b. Fit Diagrams and Facilities Master Plan

(October 2016 - February 2017)

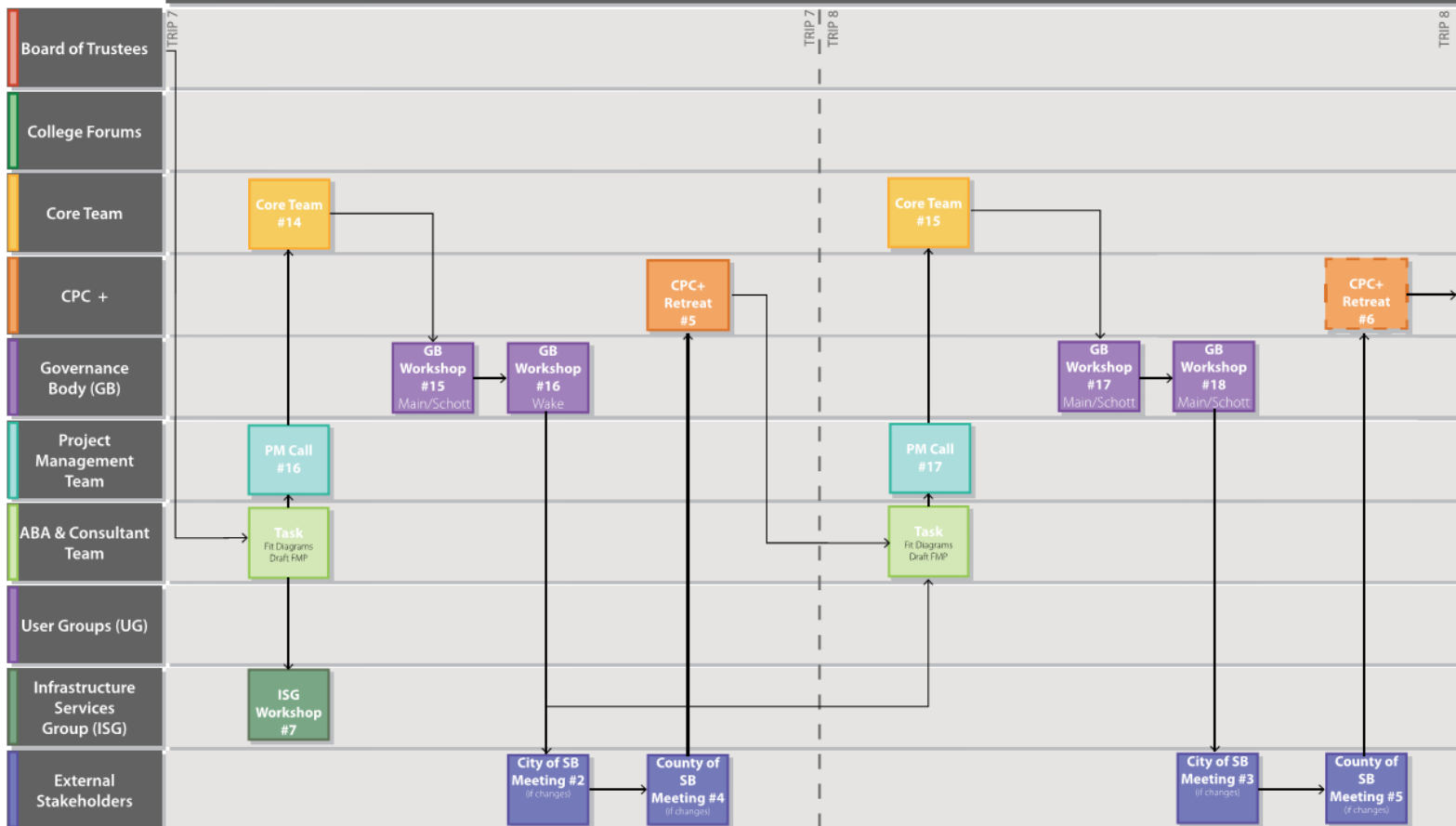

Step 3: Process Map (Step 3B : 9/2016-2/2017)

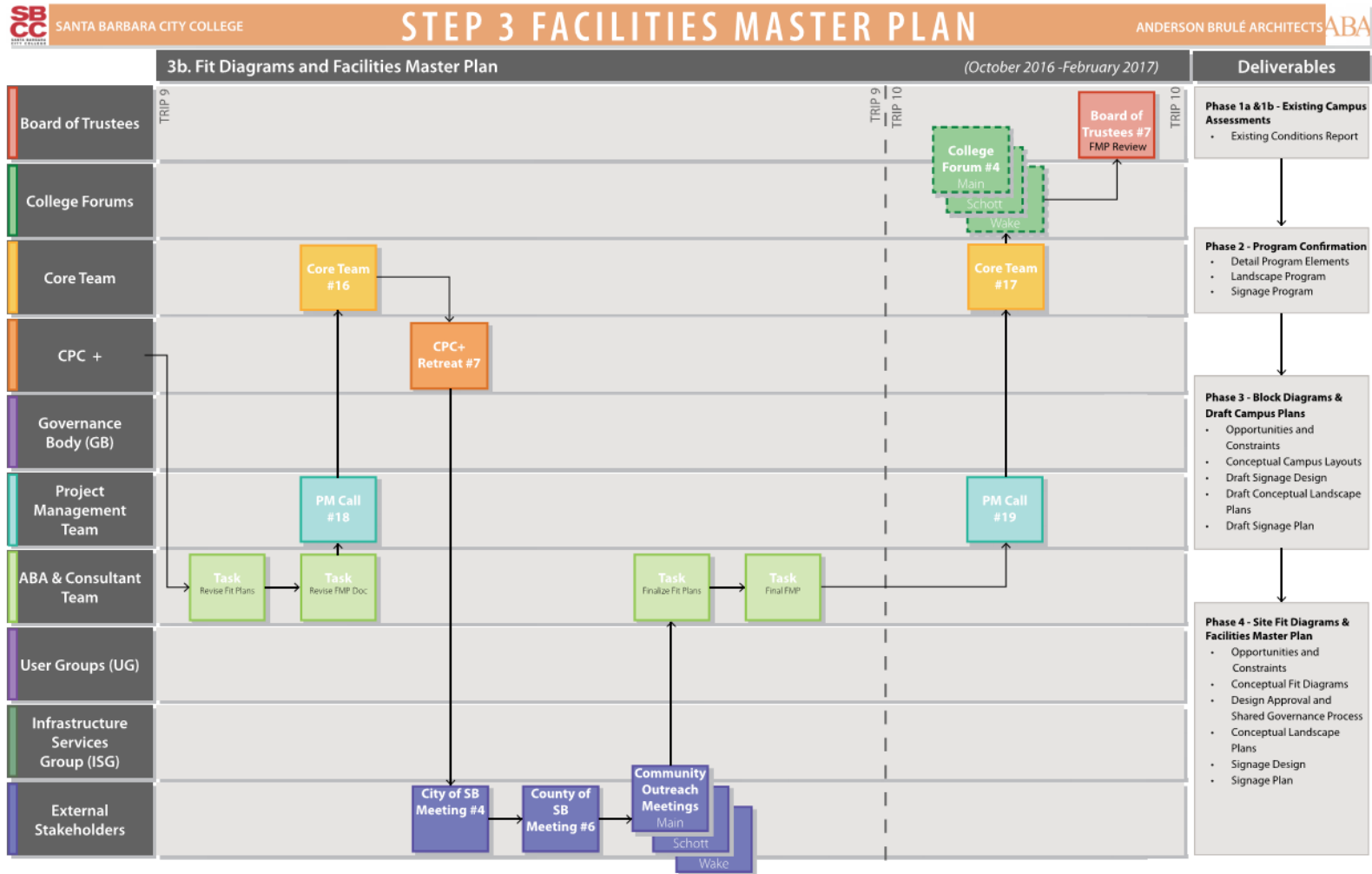



Governance Bodies Workshop

Step 3: Main Campus Building Program Scope

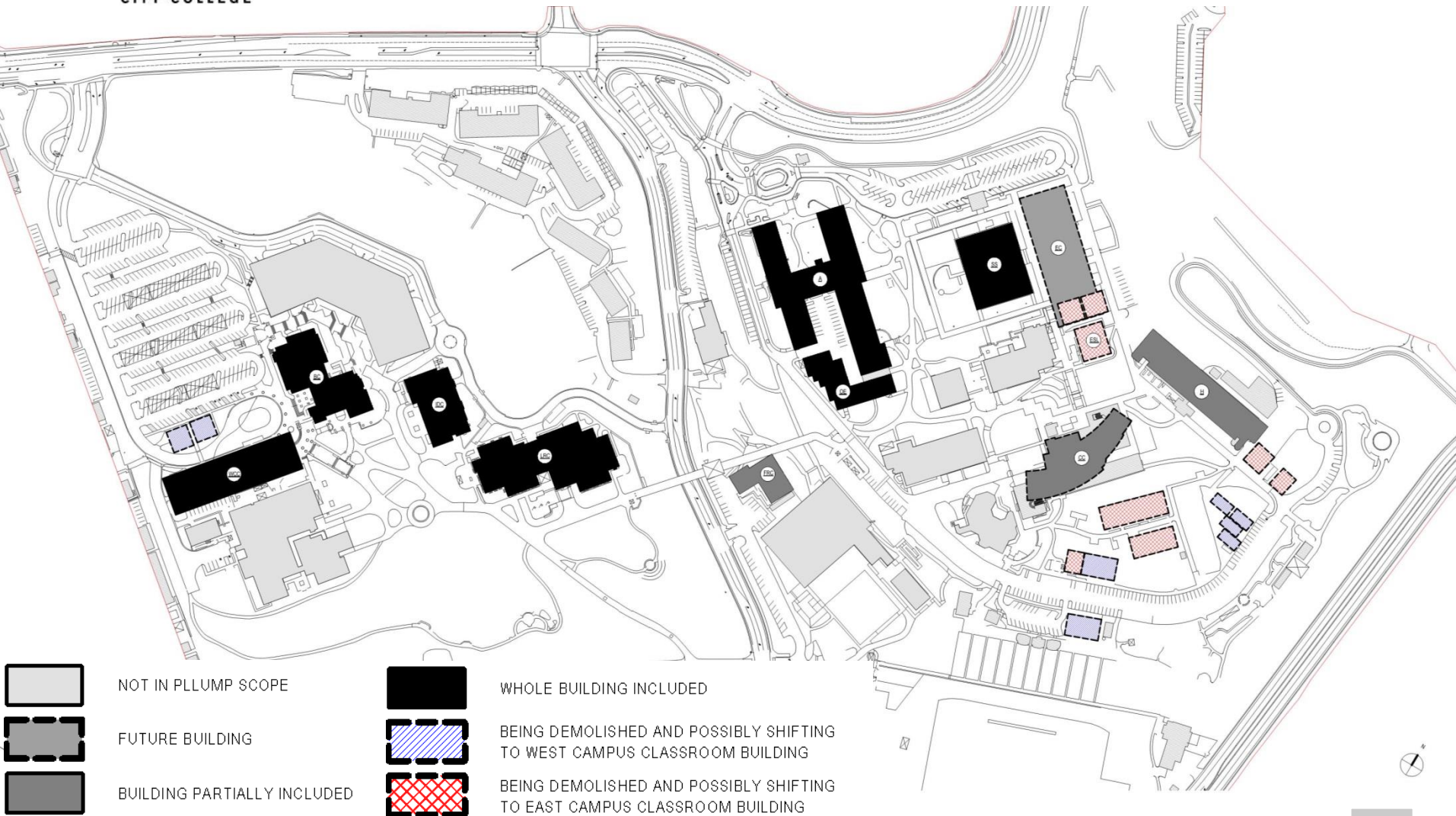

Step 3: Main Campus Existing Use Zones

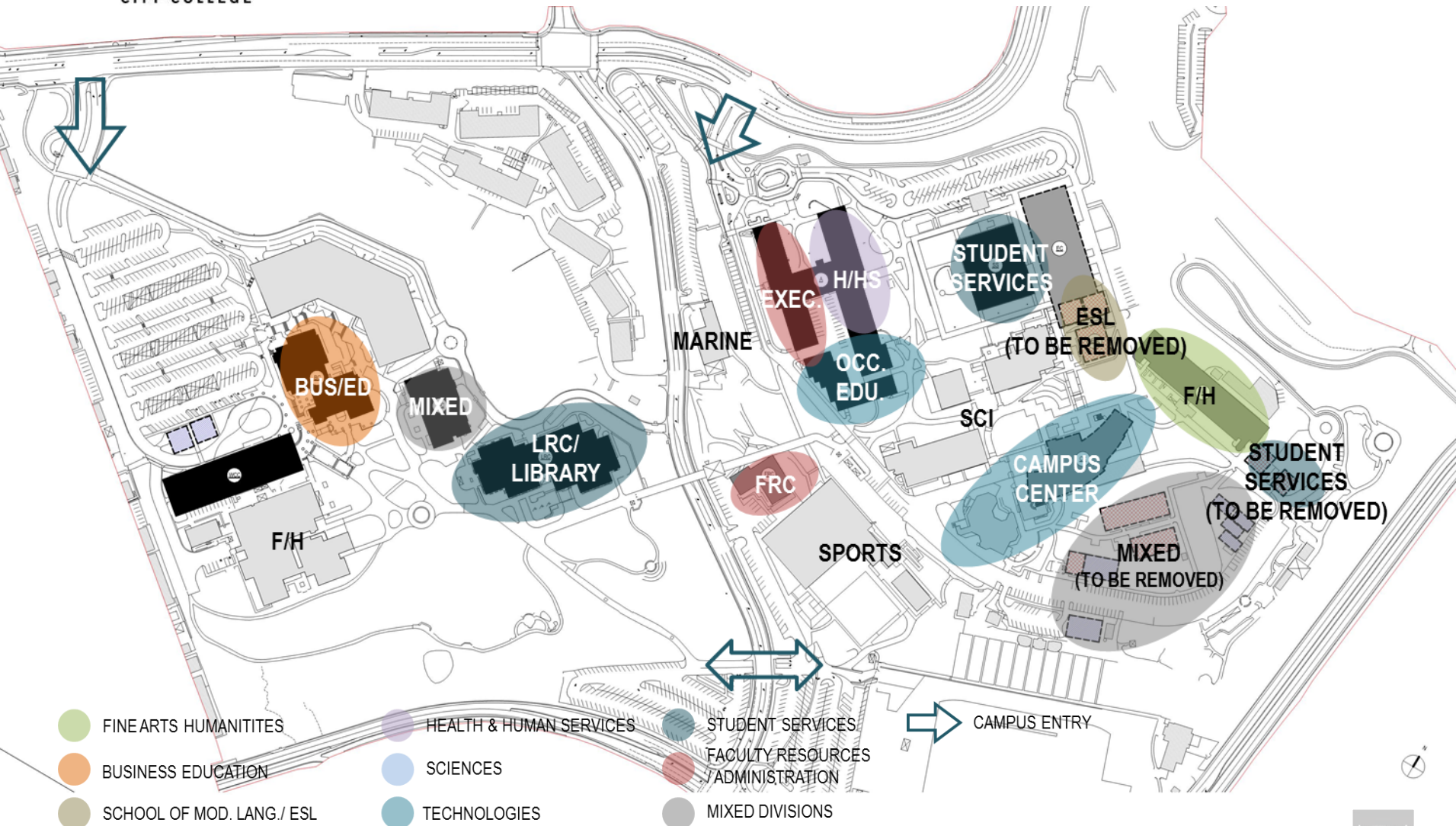

Step 3: Main Campus: CT & ISG Feedback



Key Discussion with Core Team

- Student Services Distribution
- Proximity to Tutoring
- Aligning to Educational Model
- Administration Location
- Best Use for Existing Buildings

Key Discussion with ISG

- Safety and Circulation
- Central Parking Locations
- Improved/Increase Open Space

Step 3: Main Campus: CT & ISG Feedback

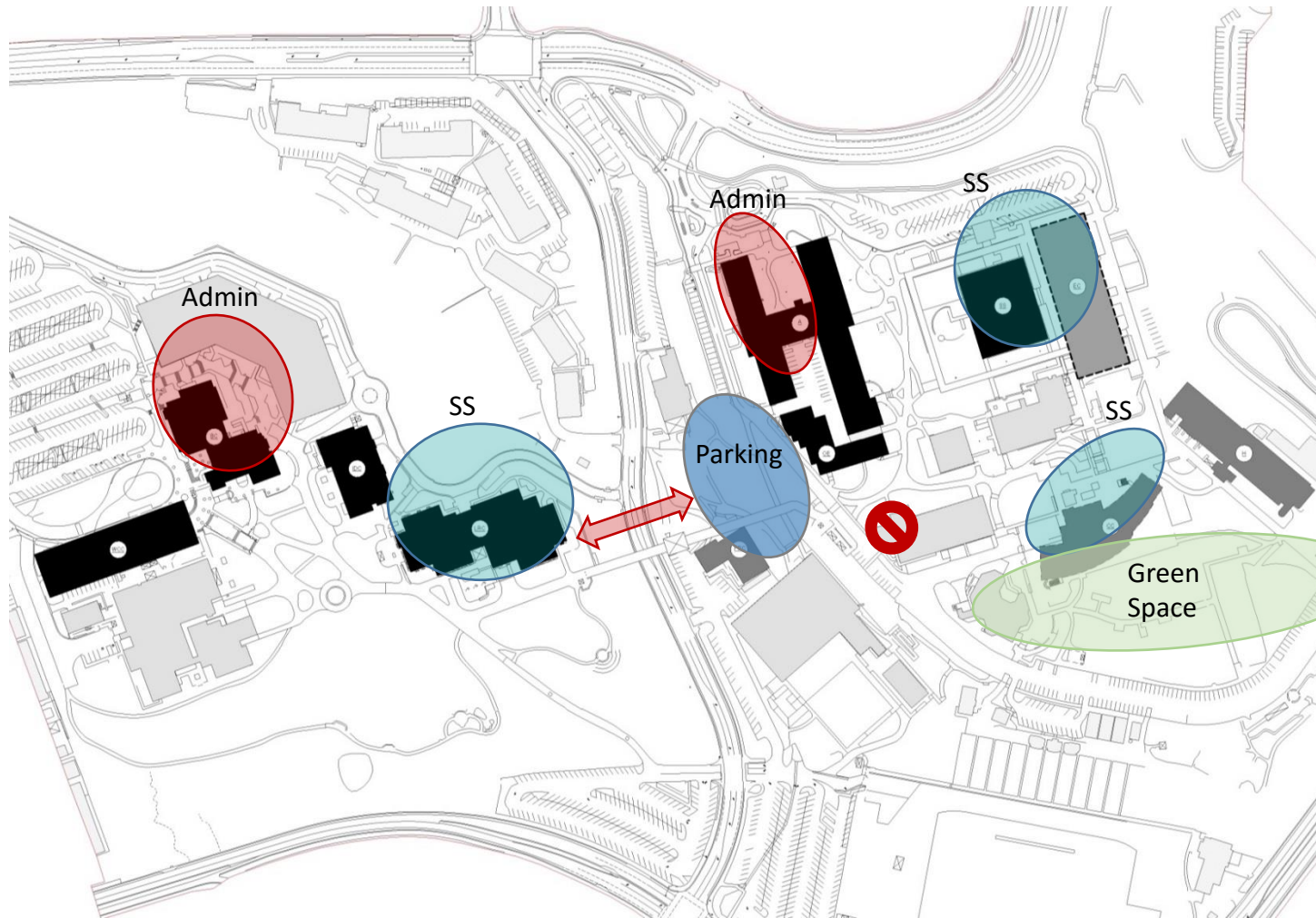

Key Discussion with Core Team

- Student Services Distribution
- Proximity to Tutoring
- Aligning to Educational Model
- Administration Location
- Best Use for Existing Buildings

Key Discussion with ISG

- Safety and Circulation
- Central Parking Locations
- Improved/Increase Open Space



Main Campus

Introduction

Exercise

Key Findings



Main Campus Introduction to Exercises

- Goals and Parameters
- Toolkit
- Instructions



Goals and parameters of scenario development

- Scenarios are not intended to be the master plan design
- Multiple perspectives in a creative forum
- Rapid prototyping of ideas
- Learning lessons through testing scenarios
- Develop opportunities and constraints
- Informs analysis and site master plan design alternatives

Step 3: Main Campus: Block Exercise



T&D

- SOML/ESL
- Fine Arts/ Media Arts (SOMA)
- Fine Arts/ Humanities
- Sciences
- Social Sciences
- Business Administration
- Technologies
- Health/ Human Services
- English
- Math
- PE/ HE/ RE
- Ed. Programs Support
 - Tech
 - Student Dev.
 - General Support

CTE

- Business Education
- Technologies
- Health/ Human Services



Main Campus Introduction to Exercises

- Toolkit
 - Space Program “Game Pieces”
 - Main Campus Site Plan

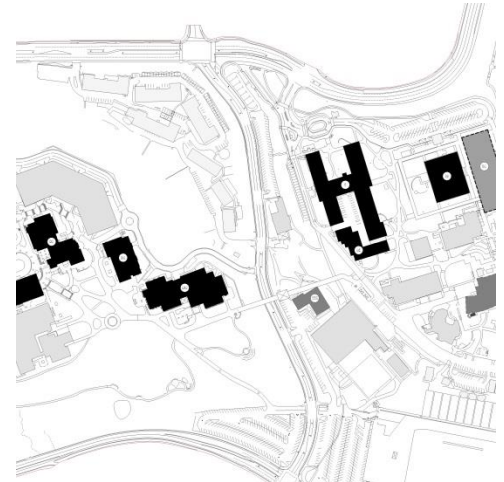
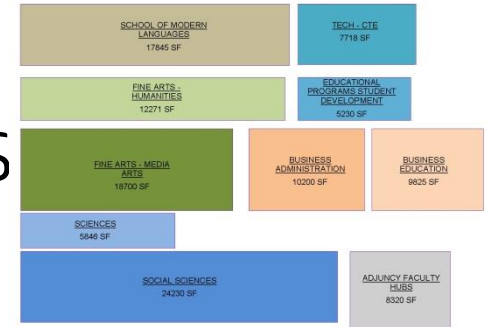



Main Campus Exercise

- As a team discuss key ideas & concepts, what works, and what does not
- Small groups of 6-7
- Develop at least two schemes
- Document the idea on trace paper
- Large group presentation
- Key Findings Presentation

Main Campus Exercise



Main Campus Exercise



Main Campus Exercise Sample



Main Campus Exercise Sample

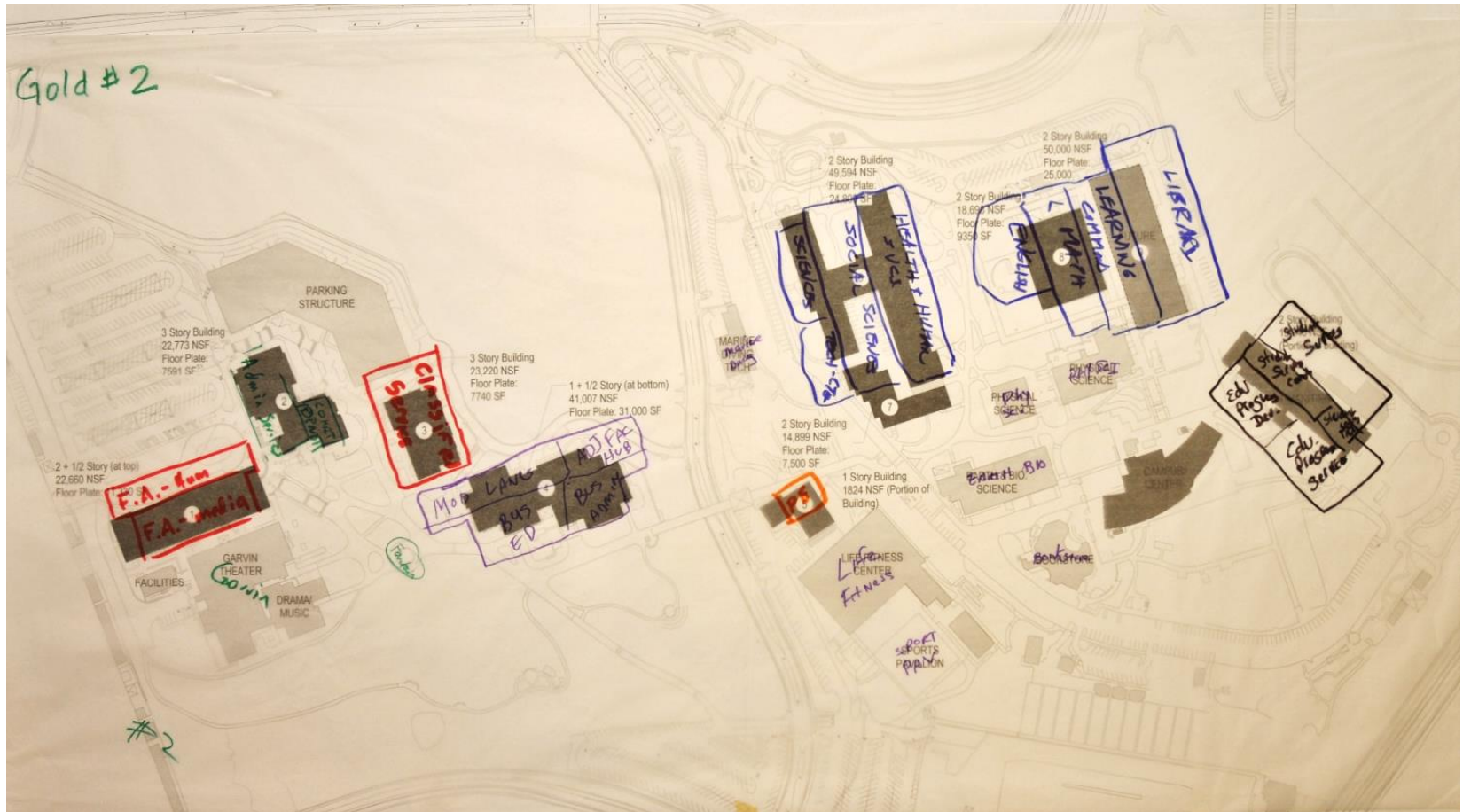



Main Campus Exercise Presentation



Main Campus Exercise Key Findings





Step 3: Site Use Zone Diagrams GB Input

Main Campus Organizing Principles

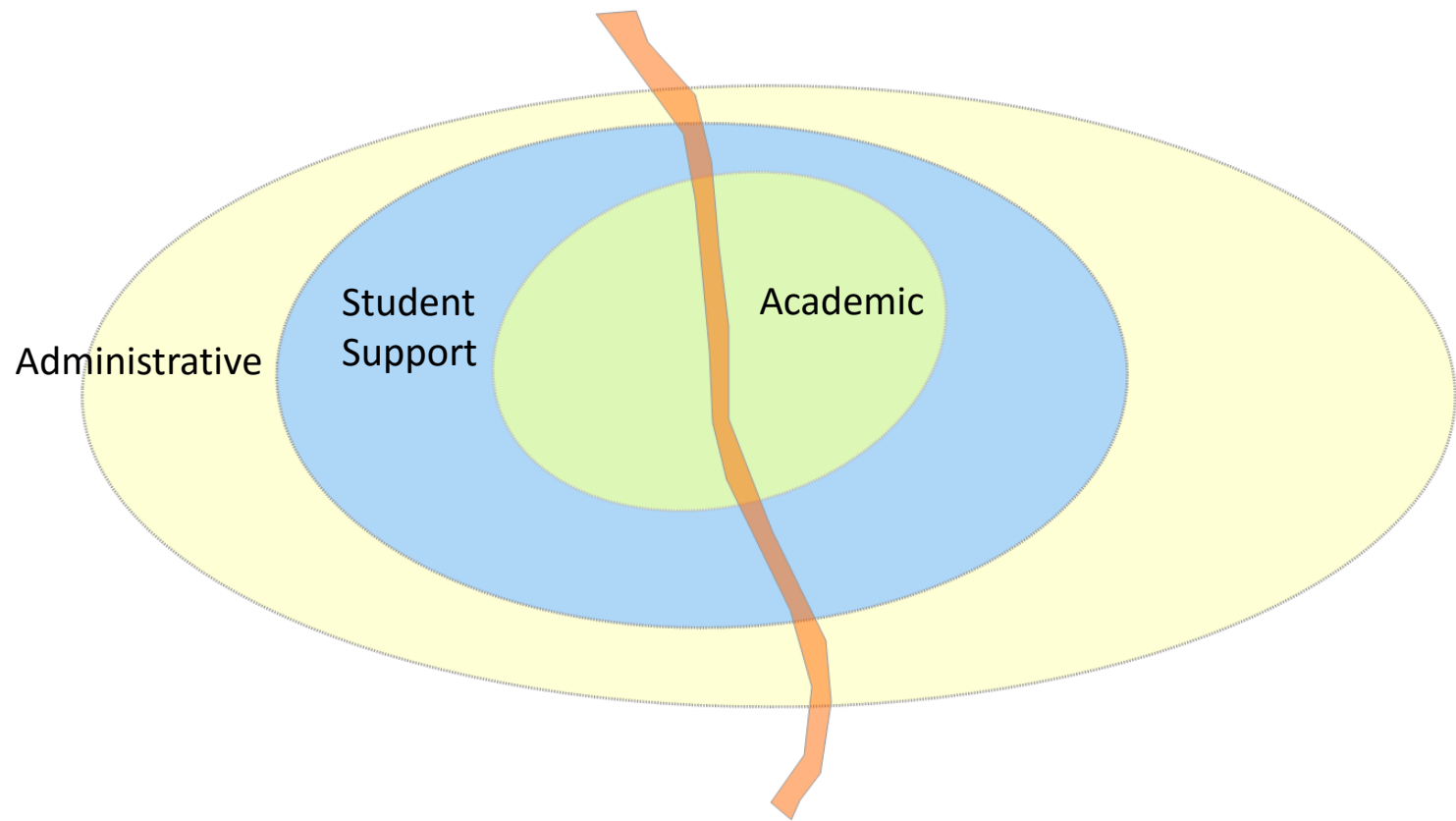

Main Campus Organizing Principles

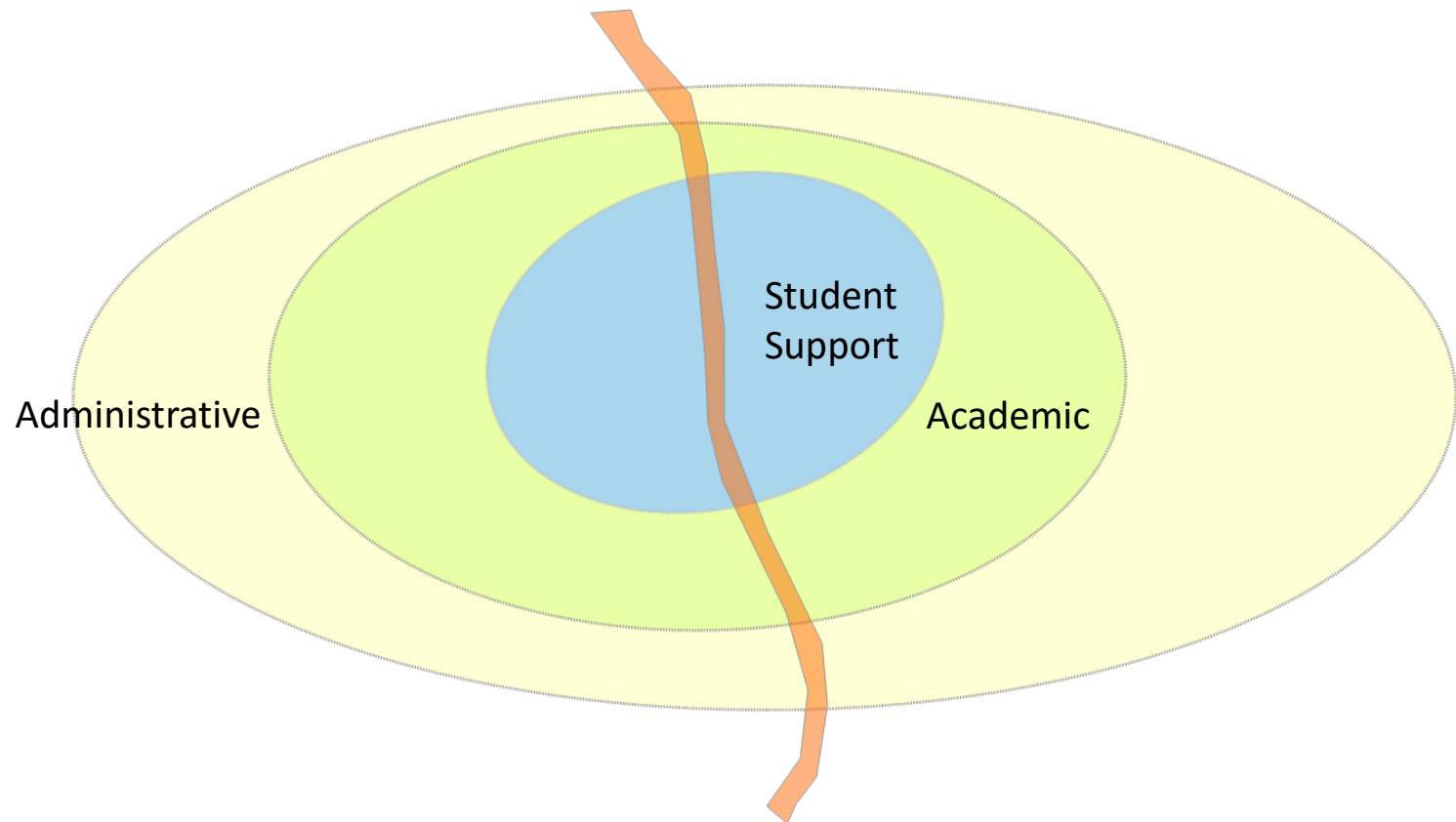

Main Campus Organizing Principles

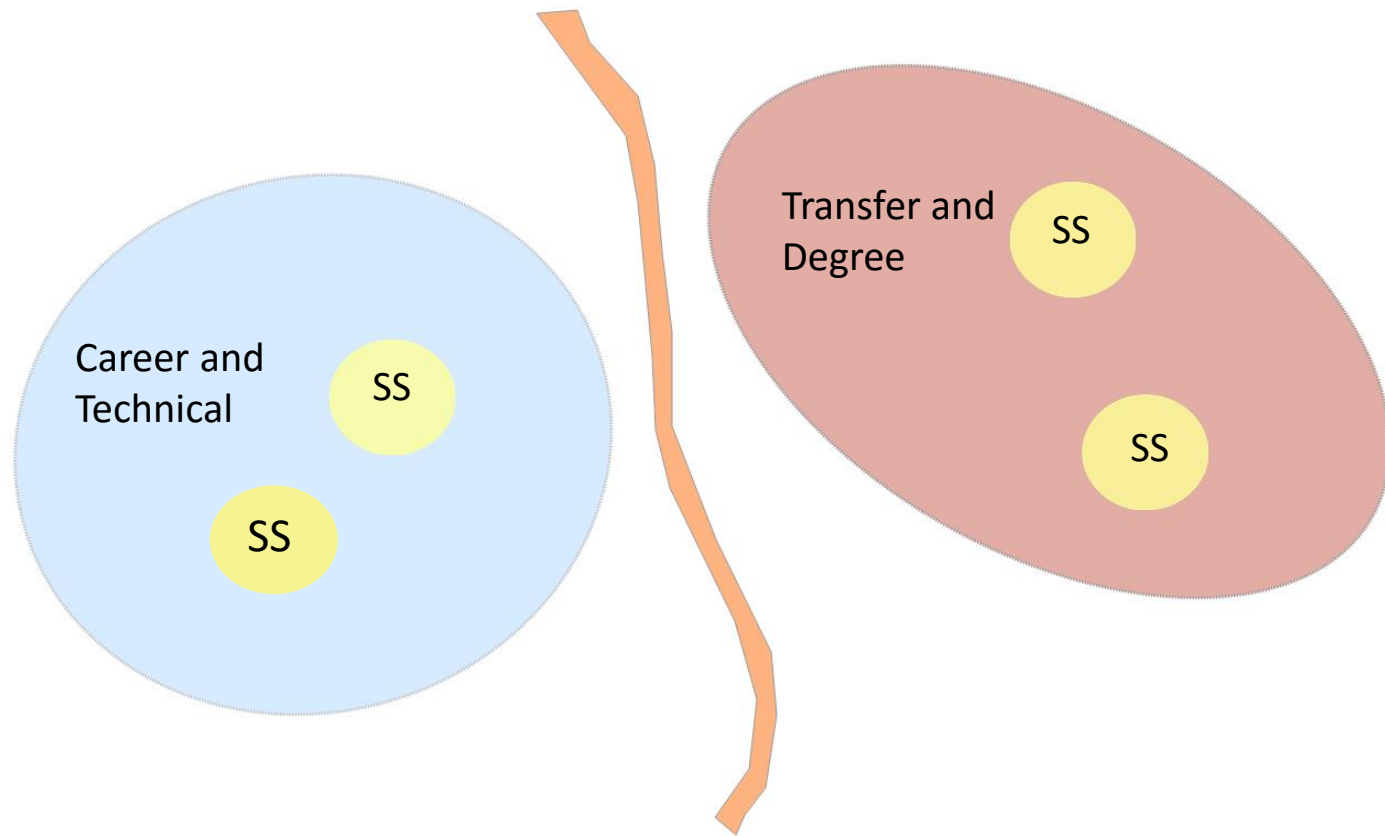

Main Campus Organizing Principles

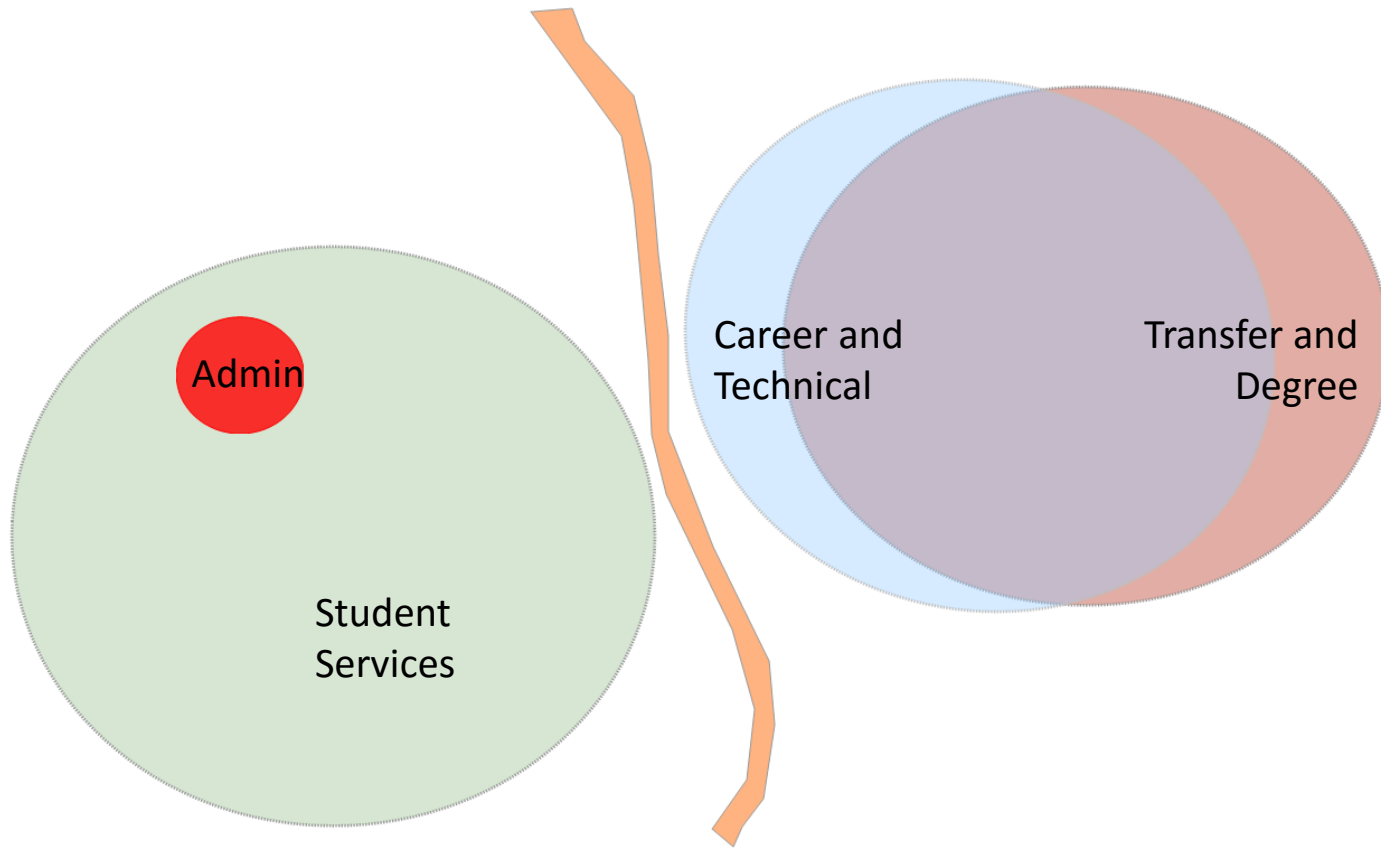



Main Campus Program Clusters

Created 11 Schemes from 6 Cross-Functional Groups, the following relationships emerged:

- Student Services (not including Library & LRC) should be consolidated (All schemes)
- Library and LRC should be together (8 schemes)
- Administrative and Classified Services should be adjacent (9 schemes)
- Social Sciences and School of Modern Languages have a relationship (7 schemes show adjacency)
- Math & English Programs have a relationship (7 schemes show adjacency)
- CTE Tech and Health/Human Services show an adjacency (7 schemes)
- Consider locating Fine Arts with Theater (5 schemes)



Main Campus Program Considerations

- Need for a Welcome Center or Prominent Entrance
- Proximity of parking to Student Services
- Proximity of Food to Students
- Proximity of Students Services to Instructional Classrooms
- Proximity of parking to Library
- Better Interaction between West and East Campus
- Safety of Pedestrian Circulation



Main Campus Program Locations: Student Services Consolidated





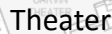



Main Campus Program Locations: Math and English

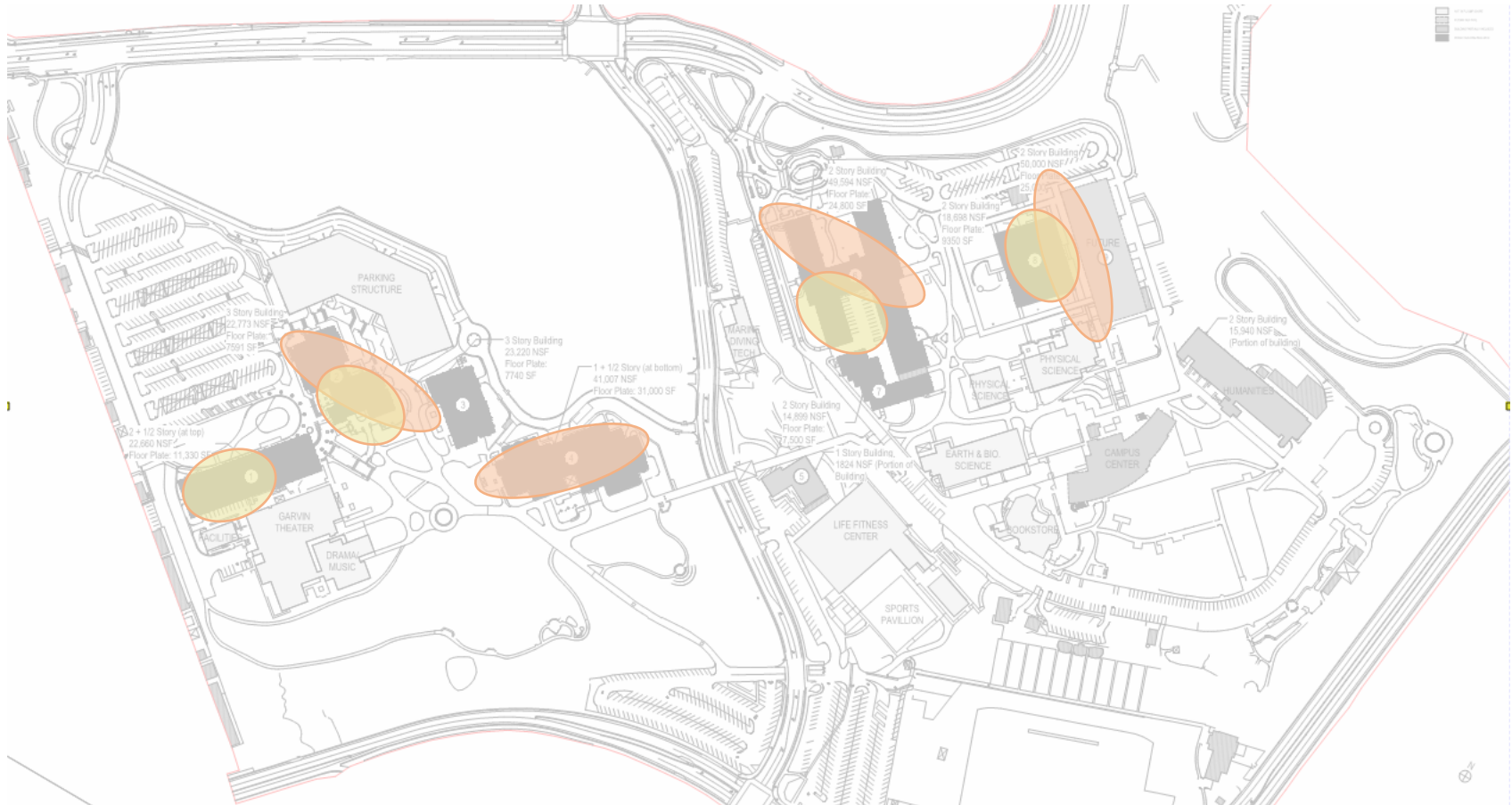





Main Campus Key Findings





Key Academic Clusters

- Modern Languages
 - Social Sciences
 - English
 - Humanities
- Social Sciences
 - Business Administration
 - Fine Arts and Humanities
 - Math and English
- Mathematics and English
 - Learning Centers
 - Tutorial

Science and Mathematics

Fine Arts

Performance Arts

Humanities (due to existing conditions)

Health & Human Services

Business Administration

Science

Student Services

Learning Commons

Social Sciences



Key Considerations for Discussion

- Where is the best location for a main entry?
- What should you find at the entry?
 - Administration Services
 - Welcome and information
 - Student Services
 - Parking
- What is the “heart” of the campus?
 - Academics
 - Library
 - Student Services
 - Food/Student gathering



Key Considerations for Discussion

- How should the educational model be organized?
 - Transfer Degree (east) and CTE (west)
 - Integration of Academics (east) other services (west)
- How is Learning Commons organized?
 - One centralized location
 - Distributed services across east and west
 - Distinction between Library (academic focus) and LRC (tutorial and CTE focused)
- Where should Faculty be located?
 - Distributed hubs within each department
 - Distributed but grouped in larger cross-department hubs
 - Single location



Wake Campus

Presentation

Feedback

Step 3: Wake Campus Existing Use Zones

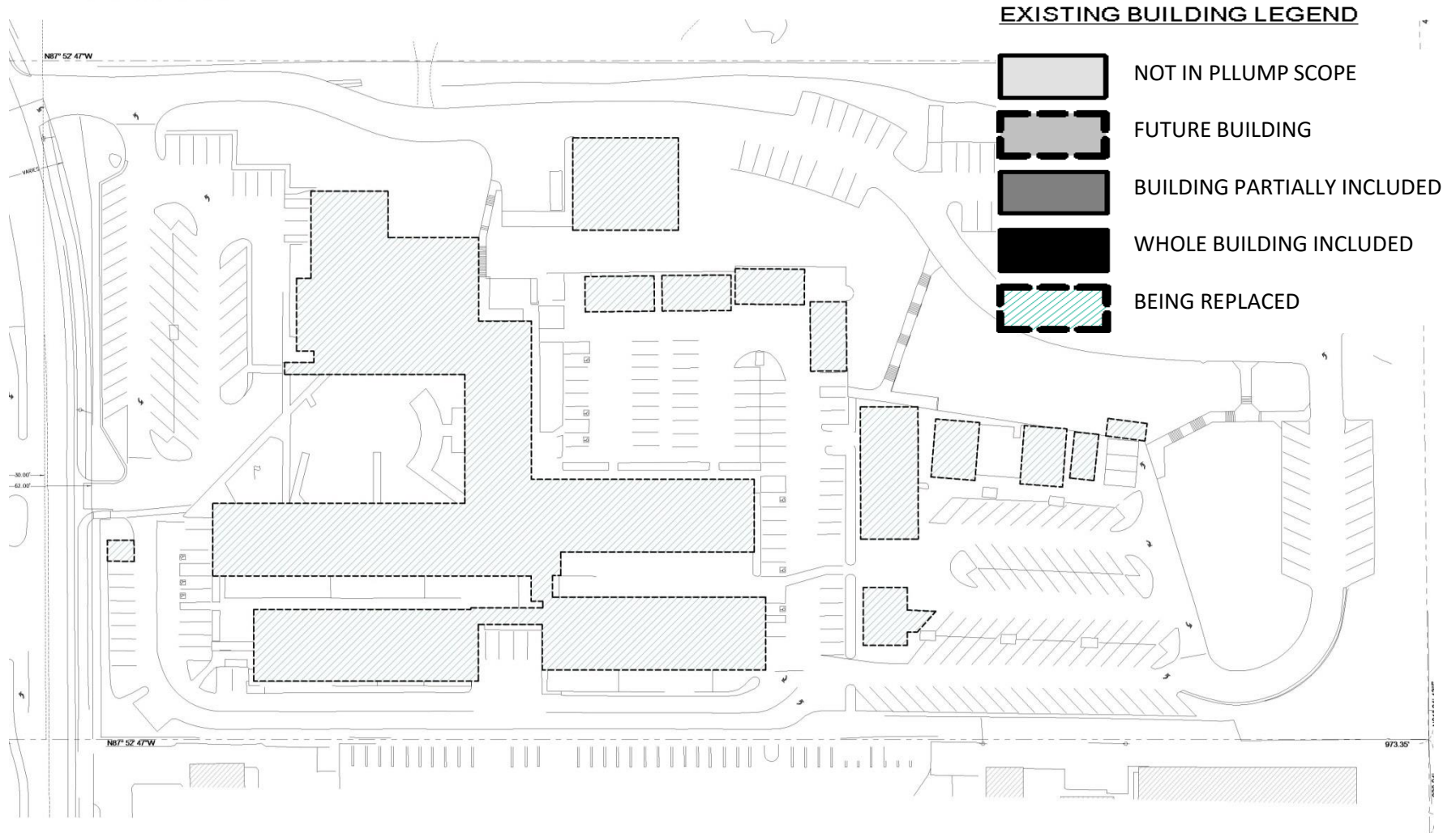

Step 3: Wake Campus Possible Use Zones

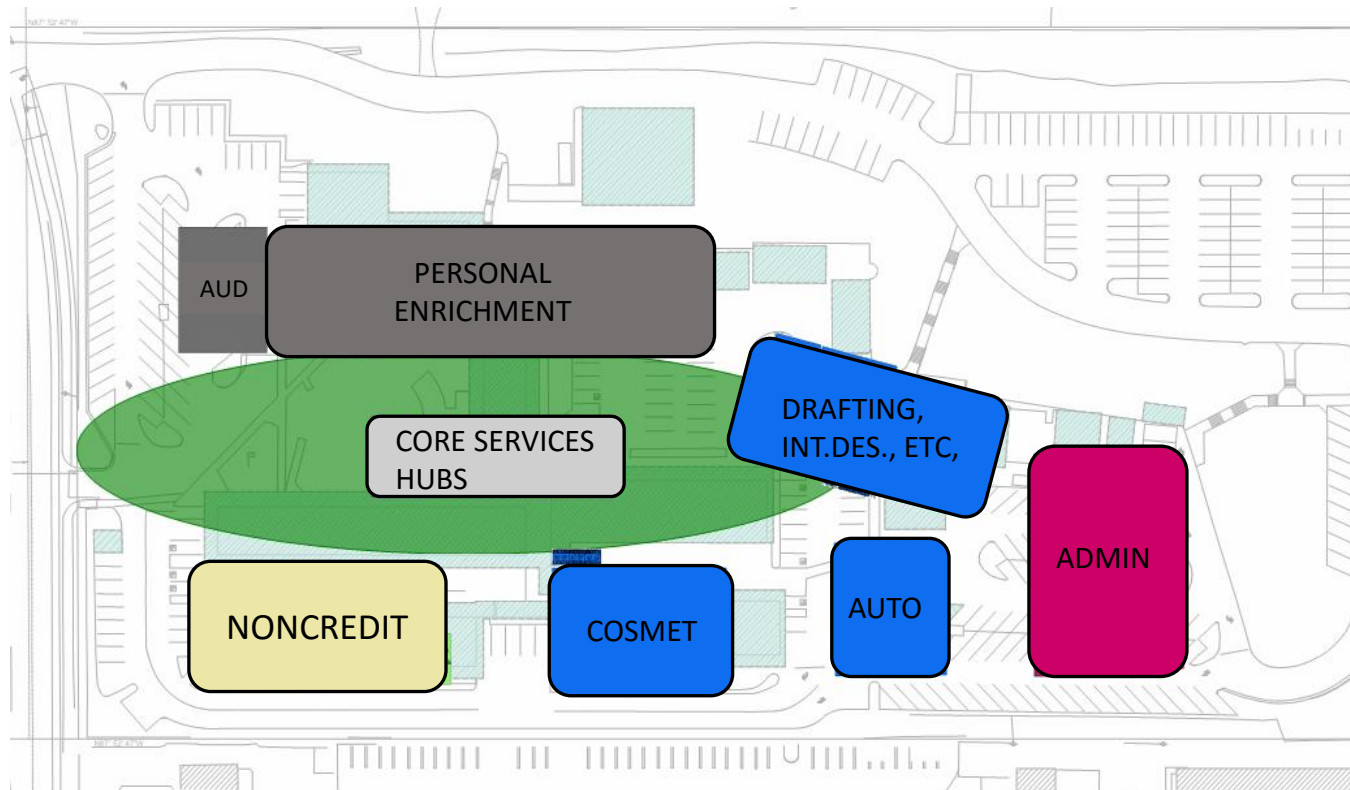

CTE Tech & Arts

- Business Education
 - Pro. Dev. Center
 - Career Skills Inst.
- Technologies
 - Automotive
 - Const. Tech
 - Cosmetology
 - Drafting/CAD
 - Interior Design
 - Integrated Design
 - Exhibition & Design

Personal Enrichment

- Arts/Crafts/Perf.

Noncredit

- Short Term Voc. (STV)



Step 3: Wake Campus Feedback

Governance Body

- Provide multilevel parking at back of site, also to provide access to programs with heavy lab use and supply needs
- Interest in increasing bus or shuttle services to site; proposed programs could increase ridership
- Concern about locating classrooms near roadways and noise
- Sensitivity to surrounding environment and neighbors related to noise and traffic
- Generally liked the overarching concept

Core Team

- A distribution facility should not be located at Wake
- Generally liked the overarching concept



Schott Campus

Presentation

Feedback



Step 3: Schott Campus Proposed Use Zones

Personal Enrichment

- Home & Family
- Body/Mind/Spirit
- Events/Language/Photo
- Nature/Science/Recreation

Noncredit

- AHS/ GED/ ESL

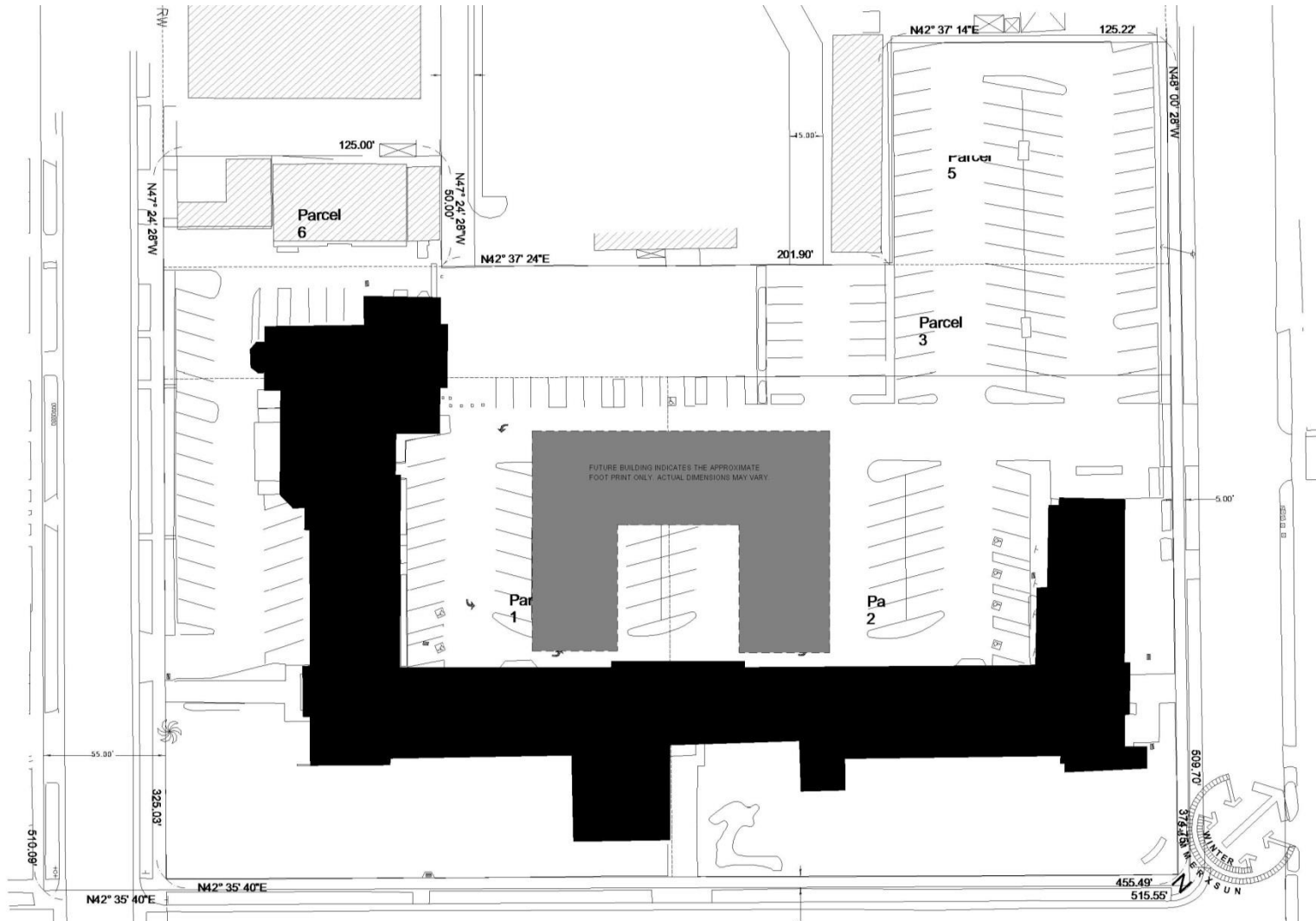

Step 3: Schott Campus Proposed Use Zones

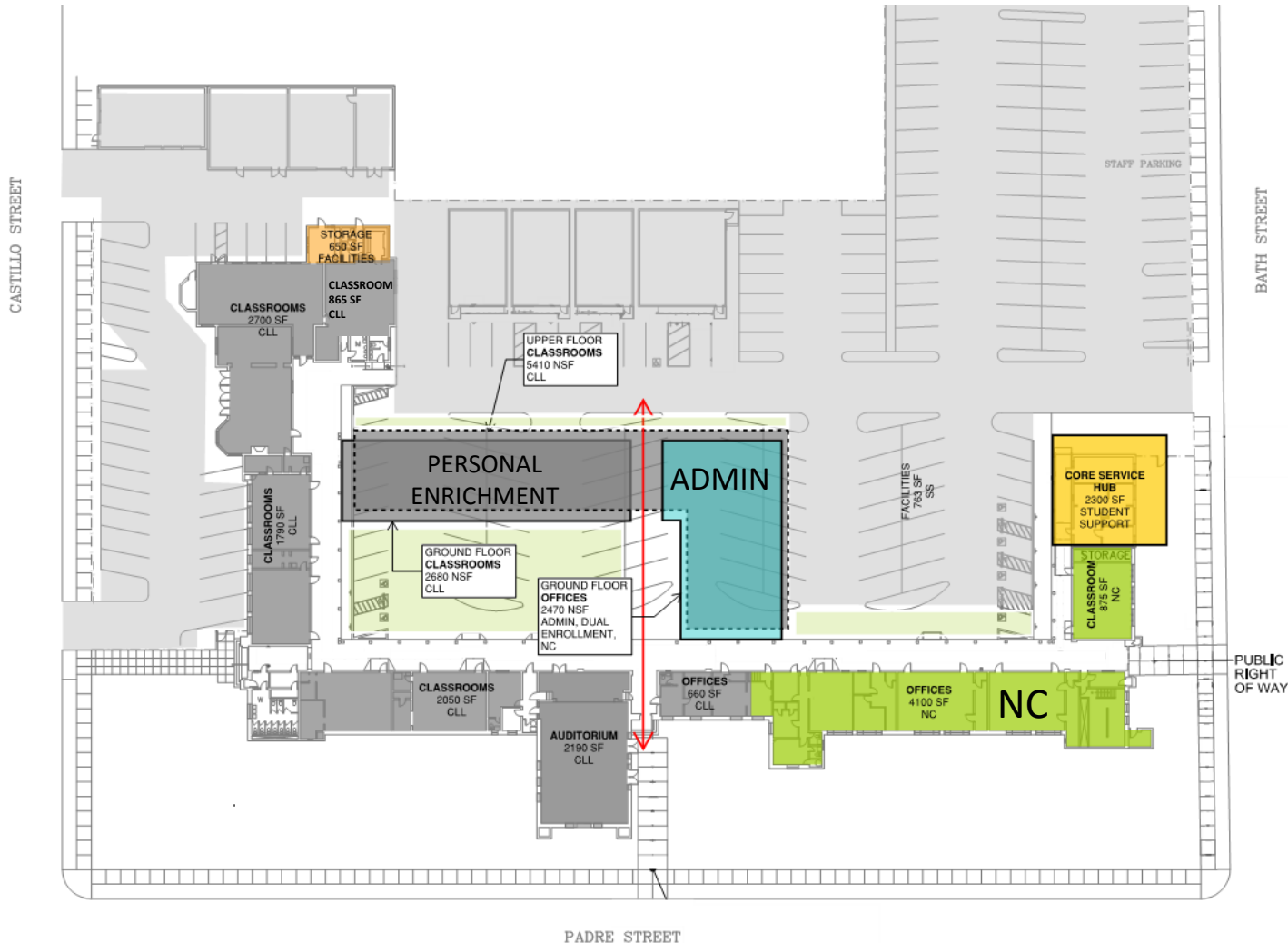

Personal Enrichment

- Home & Family
- Body/Mind/Spirit
- Events/Language/Photo
- Nature/Science/ Recreation

Noncredit

- AHS/ GED/ ESL



Step 3: Schott Campus Feedback

Governance Body

- Concept generally well liked
- Question on location of campus core
- Addition creates a garden courtyard

Core Team

- Concept generally well liked
- Appreciated the courtyard and entry concept



Step 3: CLL Feedback



Next Steps



Next Steps

- Adjacency Diagram Review
- ABA to develop initial block diagrams
- Core Team Zoom Meeting to review in June
- Agency Conference Calls Planning for June
- Community Meetings Planning for June

An aerial photograph of a coastal landscape. The top left shows a blue body of water meeting a sandy beach. The rest of the image is covered in dense, multi-colored vegetation, including various shades of green, brown, and grey, suggesting a mix of trees and shrubs. The text "Thank you!" is overlaid in white on the left side.

Thank you!